

4th Frontier of Factor Investing Conference

24th April - 26th April 2024

Lancaster University Management School (LUMS)

Information for Attendees

We are delighted that you are able to join us for this year's FoFI conference, which will take place at Lancaster University.

Please allow time to familiarise yourself with the locations of all sessions and time to arrive. There will be signs to assist you. If you are not sure, please do ask! There will be plenty Conference Team Members around and can be identified by different coloured badges. All parallel sessions will be held at the **Lancaster Conference Centre (LCC)**.

Registration will take place at the **LCC** from **10:00 hrs** on Wednesday, 24th April. **LCC** is situated at the back of Lancaster House Hotel and many of you will be staying in this hotel. **LCC** can be accessed via the hotel.

The conference ends on Friday, 26th April at 15:30 hrs.

If you are presenting at the conference, please be aware of your allocated time slot. All papers are allocated 30 mins. 25 mins presentation and 5 mins for Q&A. Please make sure you are aware of the room you are presenting in and that your presentation is uploaded in plenty of time. Your presentations should be brought with you on a pen drive. If you do not have a pen drive, please email your presentation to [FoFI Conference](#) by no later than **12:00 hrs (UK time) on Monday, 22nd April** and we will upload it on your behalf. Our four Keynotes sessions are 1-hour sessions. The full conference programme can be found [here](#).

The poster session will run during the lunch period on each day of the conference. Please refer to the [programme](#) for your slot. If you would like to have your poster printed locally, you can do so via our [Design, Photography & Print Unit](#). Please refer to their [website](#). Poster should be no bigger than A1 size and you will need to collect your poster upon arrival from Creative Studios, Lancaster Square - Room number A008, County Main, Lancaster, LA1 4YD (on campus). We will supply material for poster fixing and the support team will happily fix your poster up ahead of your session.

We will be hosting a Drinks and Canape Reception on the evening of **Wednesday, 24th April** at [The Ashton Memorial](#), Lancaster. The venue is a short ride away (10/15 mins) and a coach will be provided to take you and bring you back to campus, however, you may wish to stay in the city centre for dinner or an explore the city and the coach can drop you off in the City Centre after the Reception. If you decide to do this, you will need to make your own way back to your accommodation. The coach will leave from outside of the Management School at **18:15 hrs prompt** and return at 20:00 hrs.

Our Conference Dinner, which takes place at 19:30 hrs at the [Wyreside Hall](#), Dolphinhholme, Lancaster on the evening of **Thursday, 25th April**. The venue is a short ride away (10/15 mins) and a coach will be provided to take you and bring you back to campus with one drop off stop in Lancaster Town Centre. It will leave from outside of the Management School at **18:00 hrs prompt!**

Useful information

[Conference Venue](#)

Lancaster Conference Centre, Bailrigg, Lancaster

[Maps and Travel to Lancaster University](#)

[Maze Map](#)

[Campus Map](#)

[Parking](#)

If you're visiting campus during the day then parking charges apply. A ticket can be purchased from any of the pay and display machines across campus at a cost of £2 for two hours or £5.30 for up to 10 hours. Payments and bookings can be made via the RinGo App.

Local Taxi Numbers

+44 (0)1524 32090

+44 (0)1524 848848

If you have any additional time and wish to explore Lancaster, you might find this link useful. [Explore Lancaster](#)

Conference Links

[Programme](#)

[Accommodation](#)

If you have any queries during the conference, please contact/see Teresa on the Conference Registration Desk or any member of the Conference Committee. Alternatively, you can WhatsApp Teresa on +44 (0)75 40302028.

We look forward to seeing and welcoming you to Lancaster University on 24th April and wish you a pleasant and safe journey to Lancaster!

Local Organizers at LUMS:

Mykola Babiak, Matthias Hanauer, David Happersberger, Anastasios Kagkadis, Olga Kolokolova, Harald Lohre, Ingmar Nolte, Sandra Nolte, Carsten Rother, Mark Shackleton, Maximilian Stroh, Jerry Sun, George Wang, Chelsea Yao

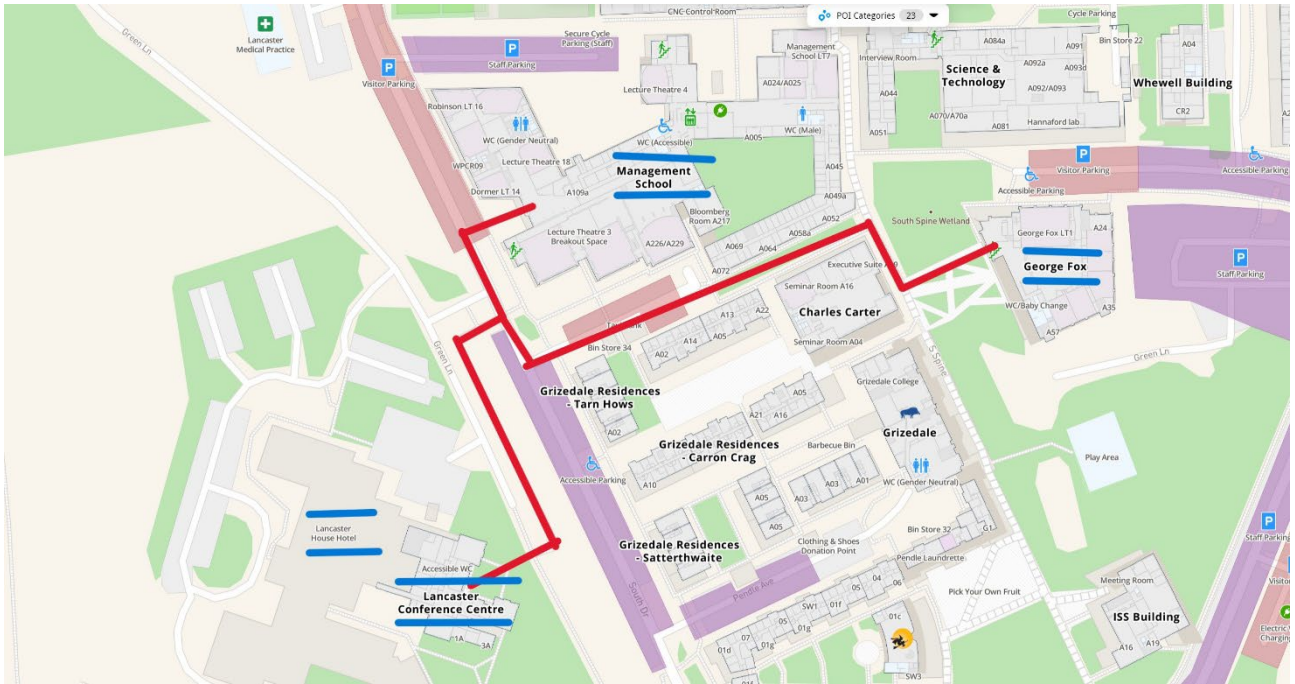

Room References

LUMS = Lancaster University Management School

LUMS WP = Lancaster University Management School West Pavilion

LHH = Lancaster House Hotel

LCC = Lancaster Conference Centre (which is situated at the back of Lancaster House Hotel)